

NOTE: DO NOT DISCARD the Parts List from the Instruction Bulletin. Place the Parts List in the appropriate place in the machine manual for future reference. Retaining the Parts List will make it easier to reorder individual parts and will save the cost of ordering an entire kit.

NOTE: Numbers in parenthesis () are reference numbers for parts listed in Bill of Materials.

Installation instructions for **kit number 9015028**

SYNOPSIS:

This kit contains the parts needed to replace the sweeping drive belt on M17 sweeper- scrubbers. Please follow step-by-step instructions.

SPECIAL TOOLS / CONSIDERATIONS: NONE

(Estimated time to complete: 45 minutes)

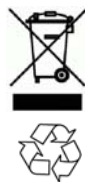

PROTECT THE ENVIRONMENT

Please dispose of packaging materials, used machine components such as batteries and fluids in an environmentally safe way according to local waste disposal regulations.

Always remember to recycle.

PREPARATION:

1. Park the machine on a clean level surface, turn off the machine, set the parking brake, and remove the key.

FOR SAFETY: Before leaving or servicing machine, stop on level surface, turn off machine, set parking brake, and remove key.

INSTALLATION:

1. Remove the left brush panel from the machine. Set the left brush panel and all mounting hardware aside. (Fig. 1)

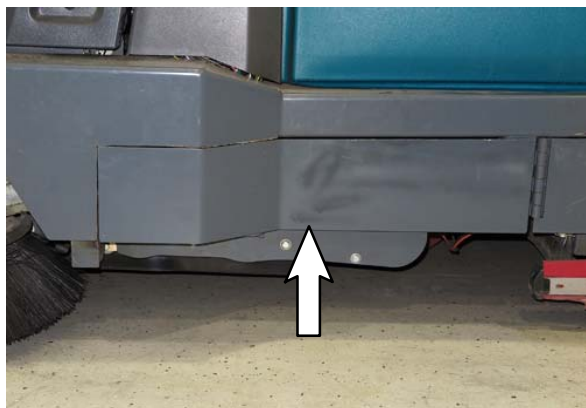

FIG. 1

2. Remove the sweeping drive belt cover from the machine. Set the sweeping drive belt cover and all mounting hardware aside. (Fig. 2 / Fig. 7)

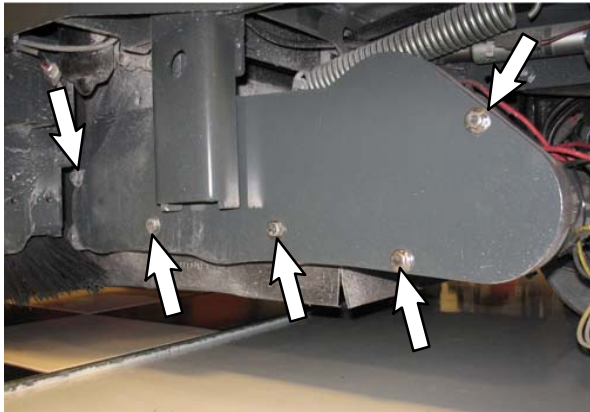

FIG. 2

3. Remove both sweeping brush drive belts from the machine. Discard both removed belts. (Fig. 7)
4. Use both M4 hex (4) screws to install the belt installation tool (3) onto one of the large sheaves. (Fig. 3)



FIG. 3

5. Position the belt (1) onto the motor sheave and then position the belt onto the belt installation tool (4). (Fig. 4)



FIG. 4

6. Turn the belt installation tool (4) / sheave clockwise to install the belt (1) onto both sheaves. (Fig. 5 / Fig. 6 / Fig. 7)



FIG. 5

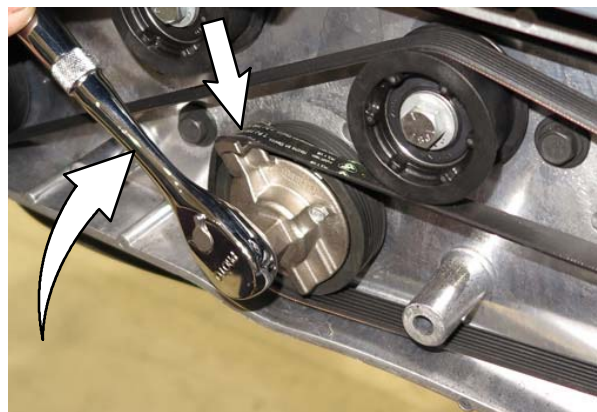

FIG. 6

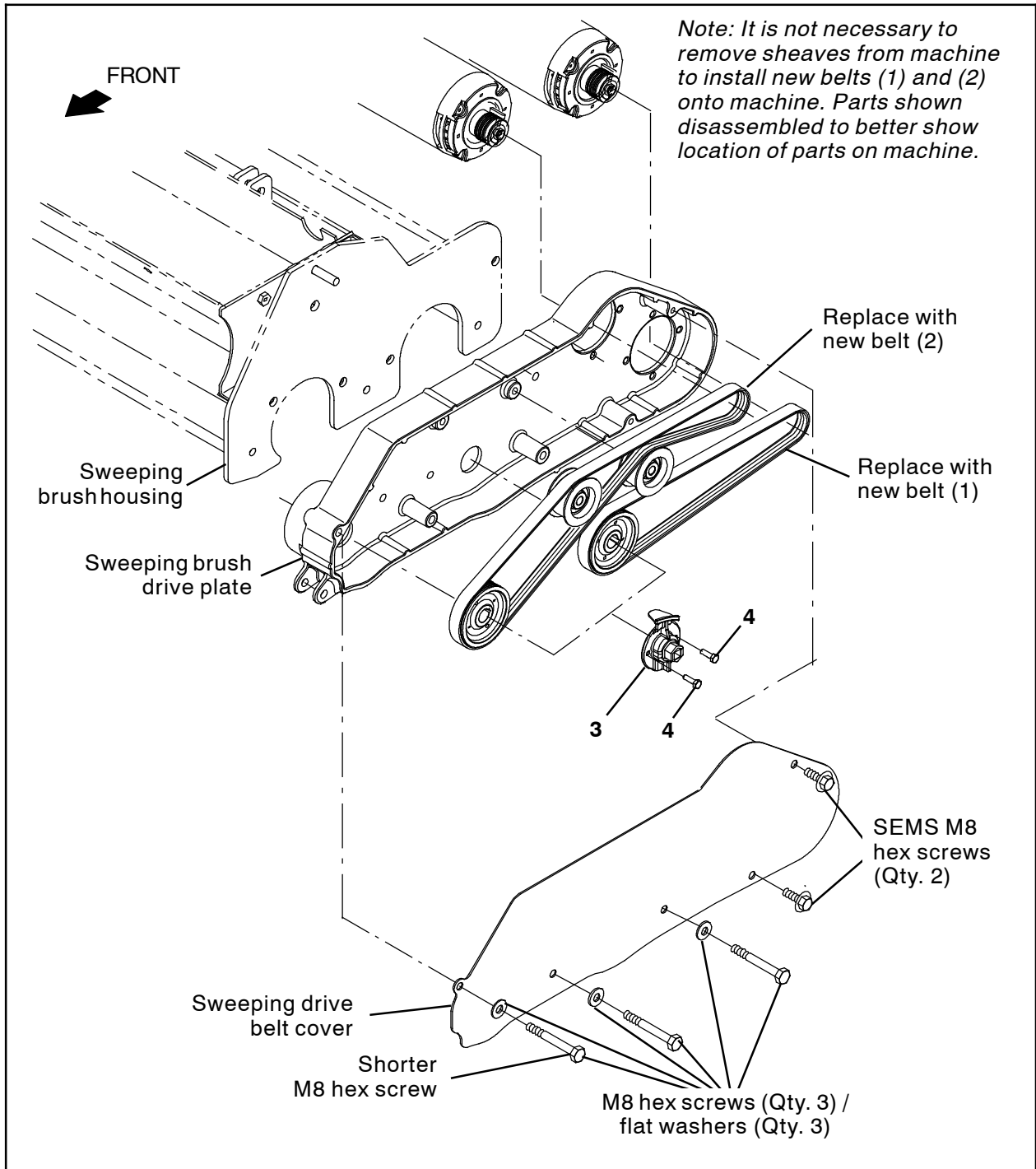

FIG. 7

7. Rotate the belt (1) on the sheaves and use fingers to work the belt the rest of the way onto the sheaves. (Fig. 8)

NOTE: Take care to not pinch fingers in the belt (1) or (2) and the sheaves while rotating the belt onto the sheaves.



FIG. 8

8. Remove the belt installation tool (3) from the sheave. (Fig. 7)
9. Repeat Step 4 through Step 7 to install the belt (2) onto the machine. (Fig. 7)
10. Remove the belt installation tool (3) from the sheave. (Fig. 7)
11. Start and test the machine. Turn on the sweeping system and observe the belts (1) and (2) to ensure they are completely installed onto the sheaves. (Fig. 7)
12. Reinstall the sweeping drive belt cover onto the machine. (Fig. 7)
13. Reinstall the left brush panel onto the machine.

Bill Of Materials For Belt Kit, Swp, Afmkt [M17] - 9015028

Ref.	Tennant Part No.	Description	Qty.
1	1217545	Belt, Ribbed, 29.8L [PJ07]	1
2	1217546	Belt, Ribbed, 40.5L [PJ07]	1
3	1221590	Tool, Installation, Belt [Lighting]	1
4	09206	Screw, Hex, M4 X 0.70 X 12, 8.8	2

TENNANT COMPANY
P. O. Box 1452
Minneapolis, MN 55440-1452